

COMMONWEALTH OF PENNSYLVANIA  
DEPARTMENT OF TRANSPORTATION  
DRAWINGS  
FOR  
CONSTRUCTION  
OF  
EUCLID BOULEVARD  
ERIE COUNTY  
WESLEYVILLE BOROUGH

TABULATION OF OVERALL/CONSTRUCTION LENGTH  
FROM STA. 0+00 TO STA. 7+55  
LENGTH 755 Ft. 0.143 Mi.

PREPARED BY:  
MARK J. COREY & ASSOCIATES  
CONSULTING ENGINEERING SERVICES  
P.O. BOX 268  
HARBORCREEK, PA 16421

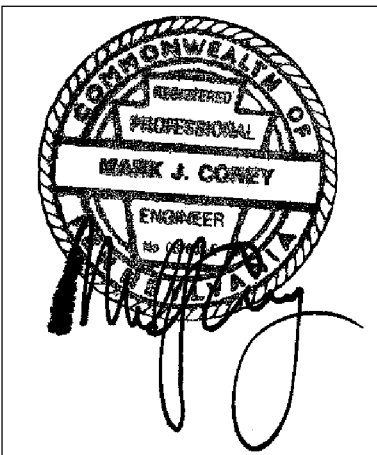

SIGNATURE: \_\_\_\_\_  
DATE: 05/13/26

RECOMMENDED DATE: \_\_\_\_\_  
\_\_\_\_\_  
DISTRICT EXECUTIVE

DISTRICT	COUNTY	ROUTE	SECTION	SHEET
1-0	ERIE	---	---	2 OF 9
WESLEYVILLE BOROUGH				
REVISION NUMBER	REVISIONS			DATE BY

## PUBLIC UTILITIES

THREE WORKING DAYS PRIOR TO START OF WORK  
 THE CONTRACTOR MUST CONTACT THE  
 PA ONE CALL SYSTEM, INC.  
 PHONE 1-800-242-1776  
 DESIGN ONE CALL  
 SERIAL #20251192167

### UTILITY INVOLVEMENT

WESLEYVILLE BOROUGH  
 ATTN: MARCUS JACOBS  
 marcus@wesleyville.gov

EVERSTREAM  
 ATTN: GEORGE CASSIDY  
 gcassidy@everstream.net

CHARTER COMMUNICATIONS  
 ATTN: MELISSA WATERS  
 melissa.waters@charter.com

NATIONAL FUEL GAS DISTRIBUTION CORP.  
 ATTN: BRANDT BAUER  
 bauerb1@natfuel.com

VERIZON NORTH  
 ATTN: VICTOR WOOD  
 victor.s.wood@verizon.com

ERIE WATER WORKS  
 ATTN: CHAD ELLSWORTH  
 cellsworth@eriewaterworks.com

PENNSYLVANIA ELEC. COMPANY  
 ATTN: MELLYSSA ADAMS  
 madams@firstenergycorp.com

## GENERAL NOTES:

ALL WORK CONTEMPLATED ON THIS PROJECT IS CONFINED WITHIN THE EXISTING HIGHWAY RIGHT-OF-WAY.

CONSTRUCT PROJECT IN ACCORDANCE WITH SPECIFICATIONS, PUBLICATION 408, 2020.

EXISTING CURB RAMPS THAT ARE COMPLIANT SHALL REMAIN.

THIS IS A FEDERAL-AID PROJECT AND AS SUCH IS SUBJECT TO INSPECTION BY REPRESENTATIVES OF THE FEDERAL HIGHWAY ADMINISTRATION, THE PENNSYLVANIA DEPARTMENT OF TRANSPORTATION, AND WESLEYVILLE BOROUGH.

THE LIMITS OF WORK ON THE INTERSECTING SIDE STREETS SHALL BE 25 FEET BEYOND THE RIGHT-OF-WAY LINE OF EUCLID BOULEVARD (EXCEPT AS OTHERWISE SHOWN).

DETAILS, OTHER THAN THOSE INDICATED, ARE ON THE FOLLOWING STANDARD DRAWINGS:

### ROADWAY STANDARDS

RC-28M    NOV 1, 2022  
 RC-30M    FEB 27, 2023  
 RC-64M    FEB 19, 2021  
 RC-67M    FEB 19, 2021  
 RC-72M    FEB 8, 2019  
 TC-8702B    JUNE 13, 2013

### RIGHT-OF-WAY BASIS

THE LEGAL RIGHT-OF-WAY OF EUCLID BOULEVARD, FROM GROVELAND AVENUE TO STATION ROAD, IS 75 FEET IN WIDTH BASED ON THE BIRD REAL ESTATE & IMPROVEMENT COMPANY MAP OF LOTS, RECORDED IN MAP BOOK VOLUME 2, PAGES 112 & 113

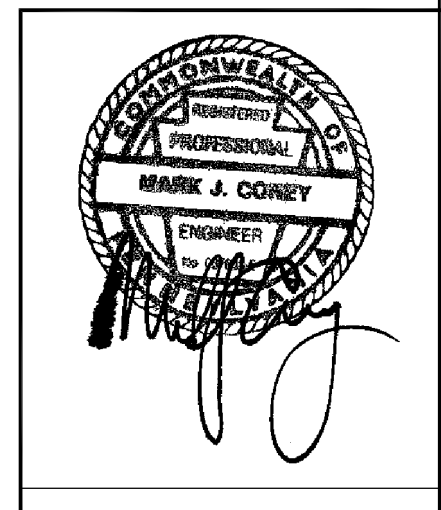

DISTRICT	COUNTY	ROUTE	SECTION	SHEET	
1-0	ERIE	---	---	3 OF 9	
WESLEYVILLE BOROUGH					
REVISION NUMBER	REVISIONS			DATE	BY

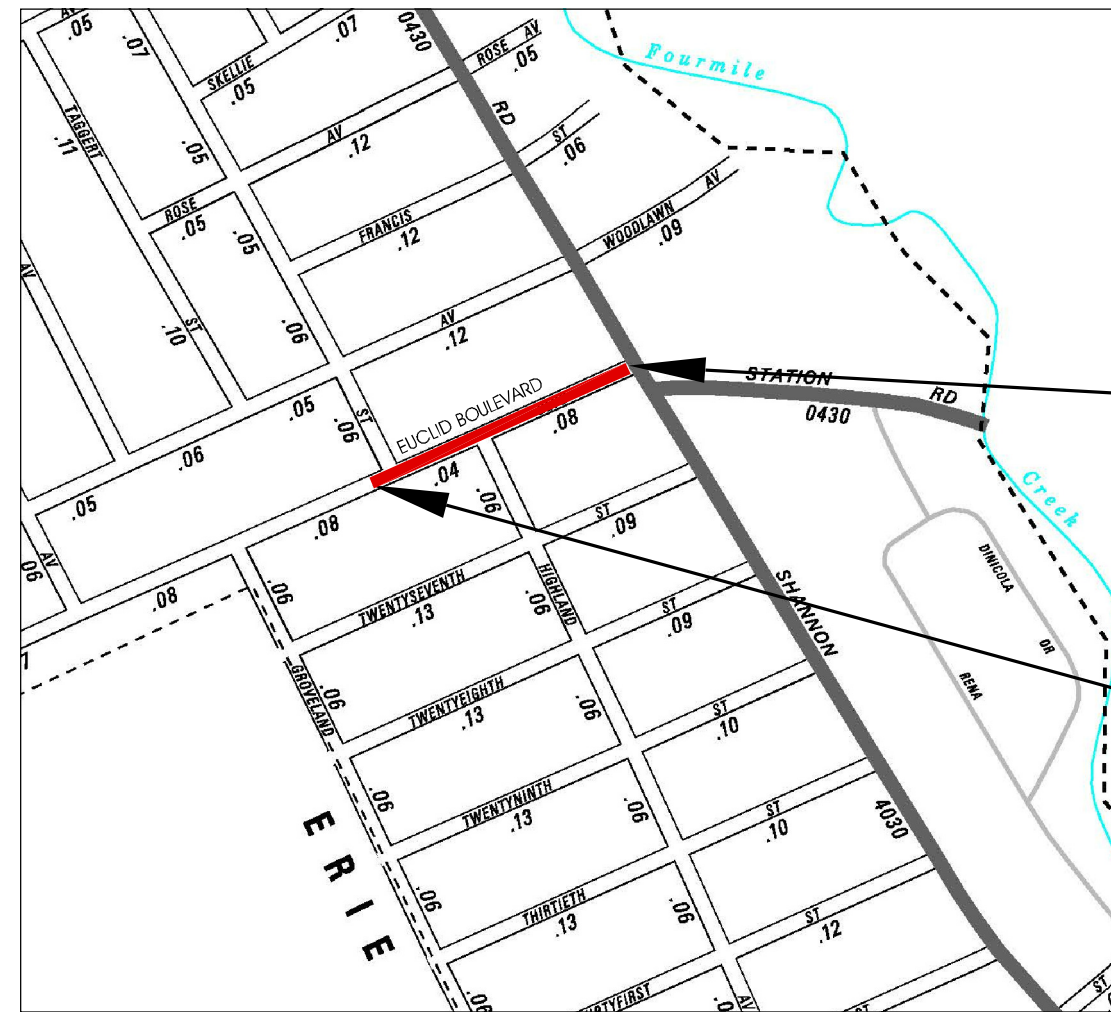

LIMIT OF WORK  
 EUCLID BOULEVARD  
 STA. 7+55  
 WESLEYVILLE BOROUGH  
 ERIE COUNTY

LIMIT OF WORK  
 EUCLID BOULEVARD  
 STA. 0+00  
 WESLEYVILLE BOROUGH  
 ERIE COUNTY

LOCATION MAP

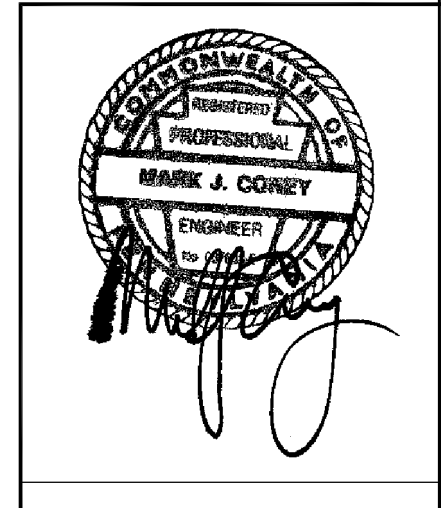
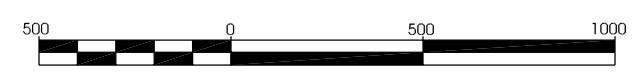



**LEGEND**

▬ LIMITS OF PAVEMENT

▬ LIMITS OF CONCRETE DRIVEWAY

DISTRICT	COUNTY	ROUTE	SECTION	SHEET	
1-0	ERIE	---	---	4 OF 9	
WESLEYVILLE BOROUGH					
REVISION NUMBER	REVISIONS			DATE	BY

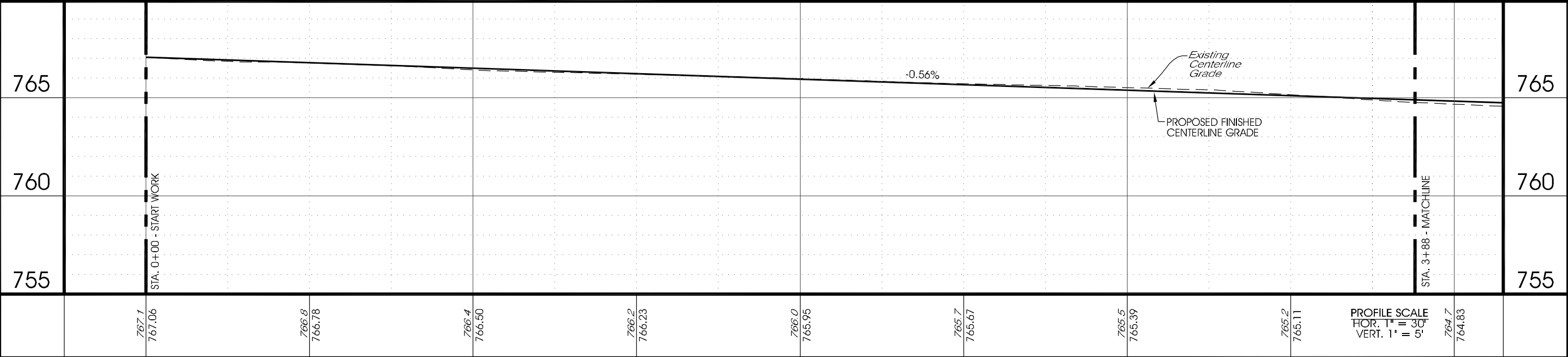
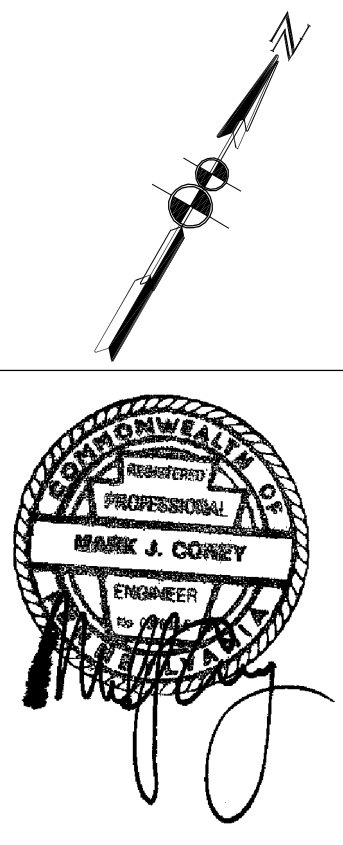
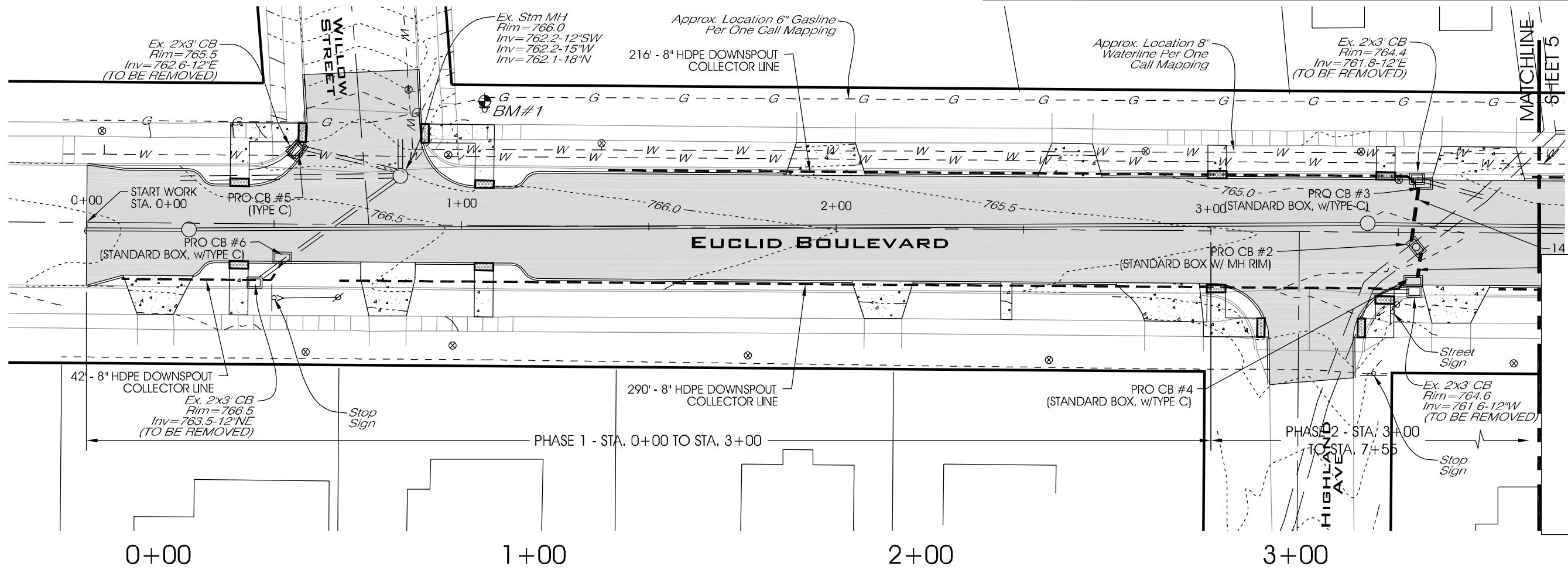

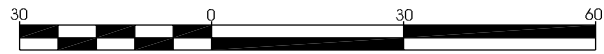

DISTRICT	COUNTY	ROUTE	SECTION	SHEET	
1-0	ERIE	---	---	5 OF 9	
WESLEYVILLE BOROUGH					
REVISION NUMBER	REVISIONS			DATE	BY

**LEGEND**

LIMITS OF PAVEMENT

LIMITS OF CONCRETE DRIVEWAY

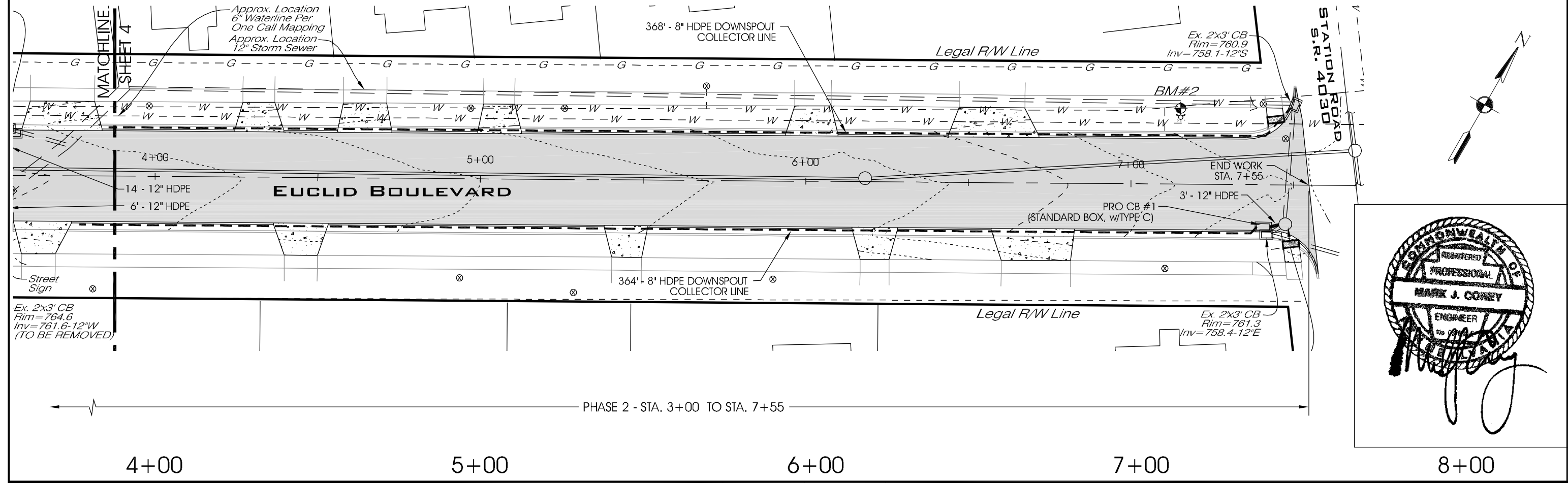

MARK J. CONEY  
ENGINEER

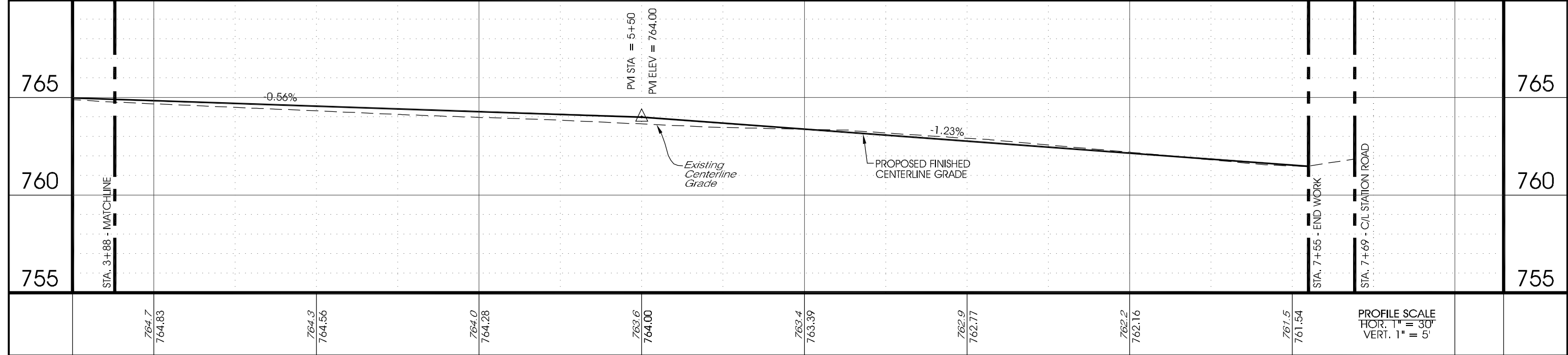

DISTRICT	COUNTY	ROUTE	SECTION	SHEET	
1-0	ERIE	---	---	6 OF 9	
WESLEYVILLE BOROUGH					
REVISION NUMBER	REVISIONS			DATE	BY

**STATIONS 0+00 TO 0+27**  
**STATION 1+25 TO 7+55**

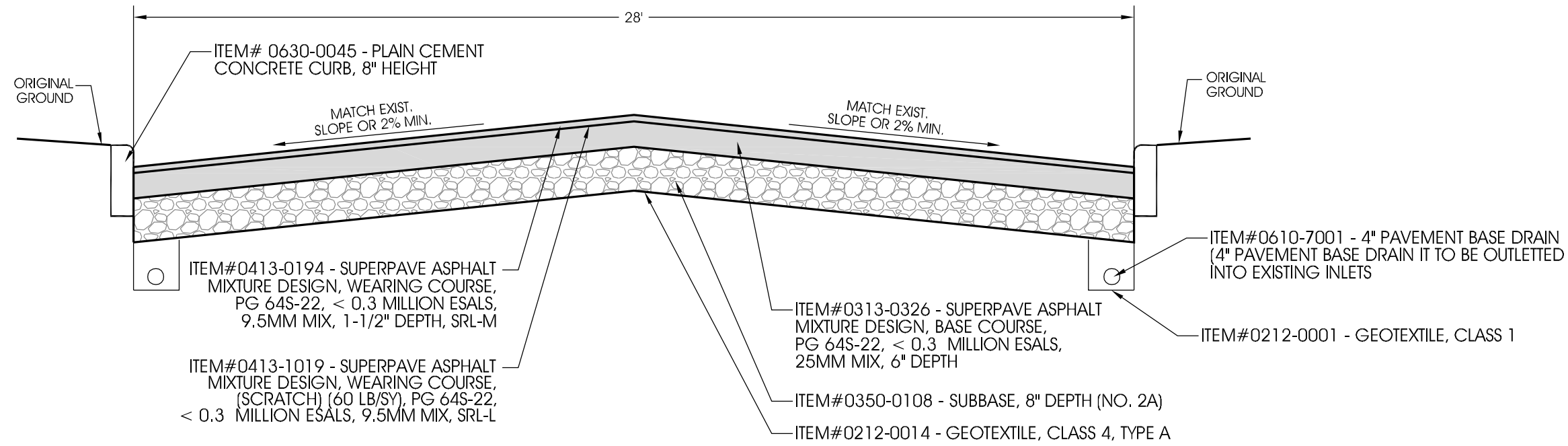

**TYPICAL SECTION**  
NOT TO SCALE

**STATION 0+27 TO 1+25**

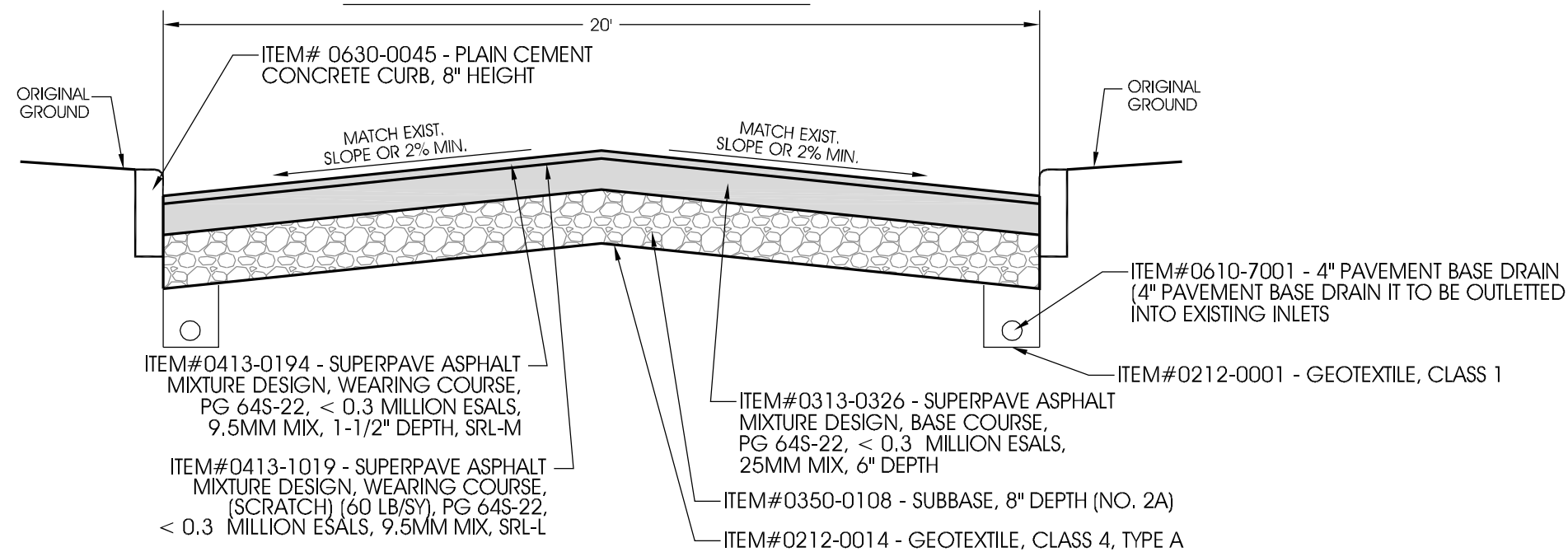

**TYPICAL SECTION**  
NOT TO SCALE

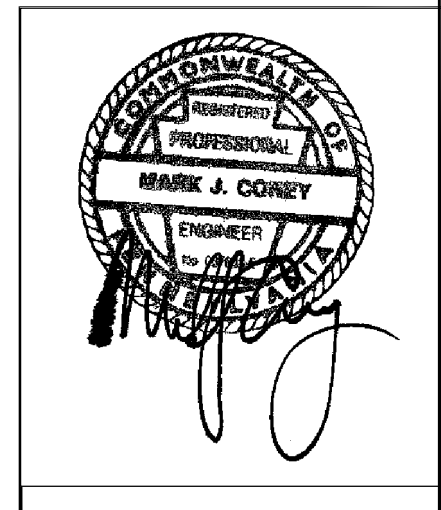

# SUMMARY

REVISION NO.	REVISIONS	DATE	BY	DISTRICT	COUNTY	ROUTE	SECTION	SHEET
				1-0	ERIE	---	---	7 OF 9

QUANTITY	ITEM NO.	DESCRIPTION	DESIGN NO.	FOR TAB SEE SHEET	QUANTITY	ITEM NO.	DESCRIPTION	DESIGN NO.	FOR TAB SEE SHEET	QUANTITY	ITEM NO.	DESCRIPTION	DESIGN NO.	FOR TAB SEE SHEET	QUANTITY	ITEM NO.	DESCRIPTION	DESIGN NO.	FOR TAB SEE SHEET
	UNIT					UNIT					UNIT					UNIT			
1200	0203 0001 CY	CLASS I EXCAVATION				0688 0020 LS	MICROCOMPUTER, TYPE C												
295	0203 0006 LF	SAWCUTTING				0689 0001 LS	NARRATIVE SCHEDULE												
867	0212 0001 SY	GEOTEXTILE, CLASS 1			48	0802 0003 SY	TOPSOIL FURNISH AND PLACE												
2474	0212 0014 SY	GEOTEXTILE, CLASS 4, TYPE A			58	0804 0025 LB	SEEDING AND SOIL SUPPLEMENTS - FORMULA B RESIDENTIAL MIX, INCLUDING MULCH												
2474	0313 0326	SUPERPAVE ASPHALT MIXTURE DESIGN, BASE COURSE, PG64S-22, <0.3 MILLION ESALS, 25MM MIX, 6" DEPTH			5	0860 0002 EA	INLET FILTER BAG FOR TYPE C INLET												
5	0350 0108 SY	SUBBASE 8" DEPTH (NO. 2A)			1500	0867 0012 LF	COMPOST FILTER SOCK, 12" DIAMETER												
2474	0413 0194 SY	SUPERPAVE ASPHALT MIXTURE DESIGN, WEARING COURSE, PG 64S-22, < 0.3 MILLION ESALS, 9.5MM MIX, 1-1/2" DEPTH, SRL-H				0901 0001 LS	MAINTENANCE AND PROTECTION OF TRAFFIC DURING CONSTRUCTION												
2474	0413 1019 TONS	SUPERPAVE ASPHALT MIXTURE DESIGN, WEARING COURSE, (SCRATCH) (60 LB/SY), PG 64S-22, < 0.3 MILLION ESALS, 9.5MM MIX, SRL-L			69	4676 0001 SY	CEMENT CONCRETE SIDEWALK FOR ADA RAMPS												
2474	0460 0003 SY	ASPHALT TACK COAT (NIT / CNT)			288	4676 0005 SY	DRIVEWAY APRONS AND SIDEWALK THROUGH DRIVEWAYS												
23	0601 0311 LF	12" THERMOPLASTIC PIPE, GROUP I, 15'-1.5' FILL			14	4695 0004 EA	DETECTABLE WARNING SURFACE, POLYMER COMPOSITE COLOR SPECIFIC												
1	0605 2401 EA	MANHOLE FRAME AND COVER			1280	9000 0001 LF	8" HDPE DOWNSPOUT COLLECTOR LINE												
5	0605 5721 EA	TYPE C CONCRETE TOP UNIT, 8" CURB HEIGHT AND BICYCLE SAFE GRATE			14	9000 5002 EA	CURB RAMP ANALYSIS WITH LIMITED SUBMISSIONS												
6	0605 2850 EA	STANDARD INLET BOX, <math>\leq 10'</math>				9000 5101 LS	ELECTRONIC TICKETING (E-TICKETING) FOR CONSTRUCTION AGGREGATE												
	0608 0001 LS	MOBILIZATION				9000 5103 LS	ELECTRONIC TICKETING (E-TICKETING) FOR CONSTRUCTION CONCRETE												
	0609 0009 LS	EQUIPMENT PACKAGE																	
1560	0610 7001 LF	4" PAVEMENT BASE DRAIN																	
1568	0630 0045 LF	PLAIN CEMENT CONCRETE CURB, 8" HEIGHT, INCLUDING REMOVAL OF EXISTING CURB																	
28	0676 0001 SY	CEMENT CONCRETE SIDEWALK																	

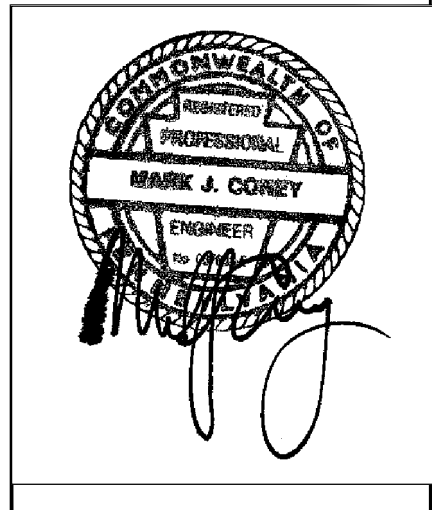

# TABULATION OF QUANTITIES

## ROADWAY

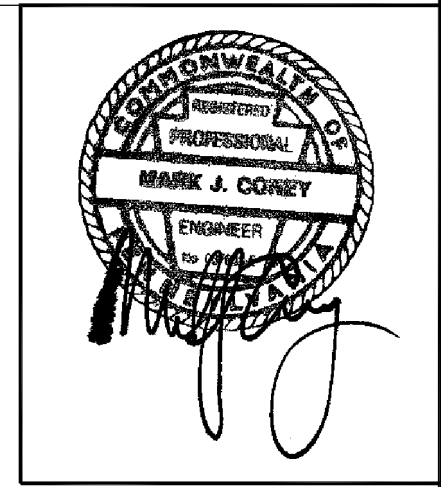

0203 0001 CY	0203 0006 LF	0212 0001 SY	0212 0014 SY	0313 0326 SY	0350 0108 SY	0413 0194 SY	0413 1019 SY	0460 0003 SY	0601 0311 EA	0605 2401 EA	0605 5721 EA	0605 2850 EA	0610 7001 LF	0630 0045 LF	0676 0001 SY	0802 0003 SY	0804 0025 SY	0860 0002 EA	ITEM NUMBER	UNIT	REMARKS	SIDE	STATIONS
1200		867	2474	2474	2474	2474	2474	2474	23	1		1							5		LT&RT	0+00 to 7+55	
	130										2	2	780	760	12	20	26				LT	0+00 to 7+55	
	165										3	3	780	808	16	28	32				RT	0+00 to 7+55	
1044	295	867	2474	2474	2474	2474	2474	2474	23	1	5	6	1560	1568	28	48	58	5		TOTALS			

